

Denotes Indicative Driveway Location

PIMPAMA RIVER

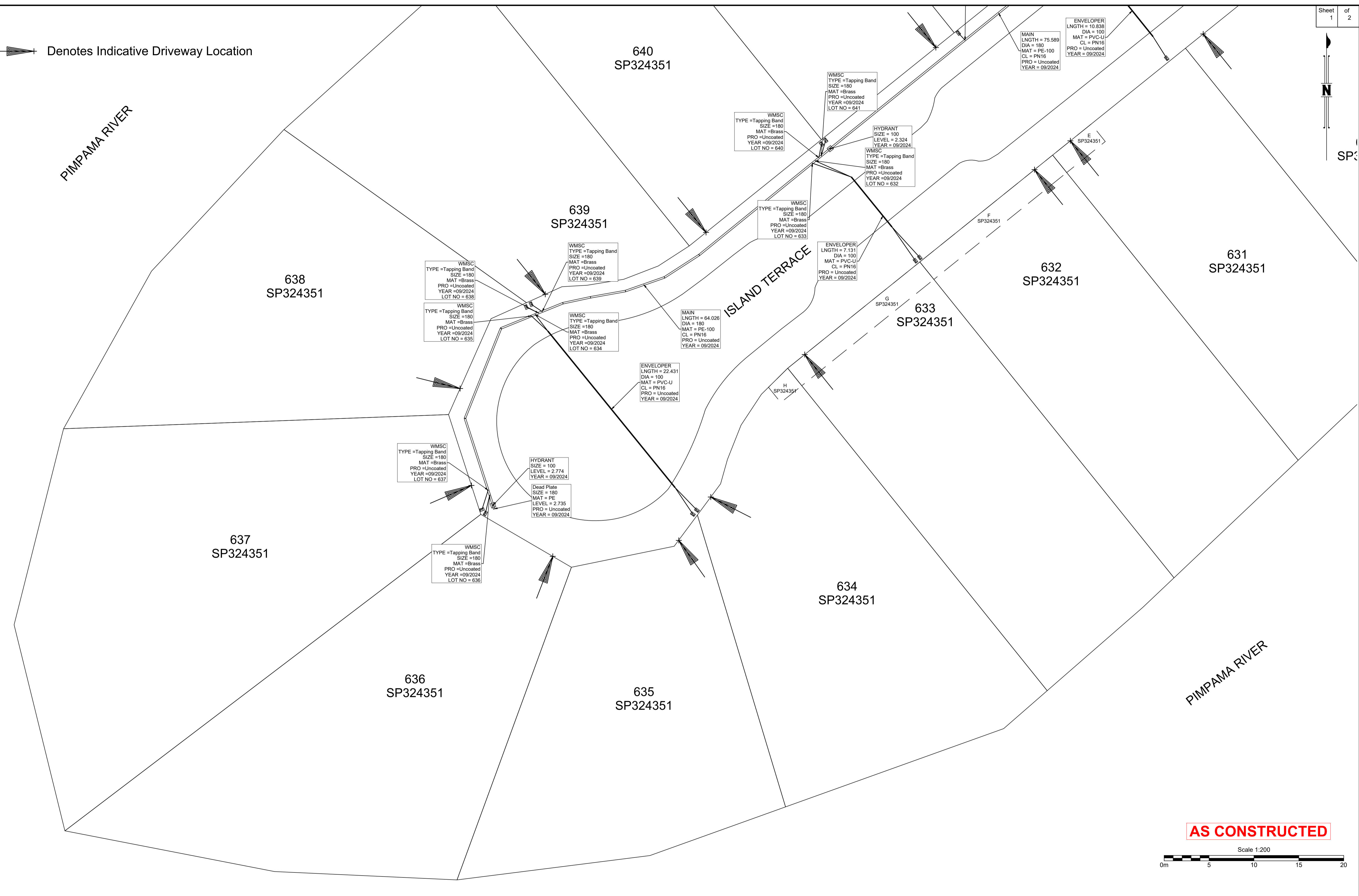

AS CONSTRUCTED

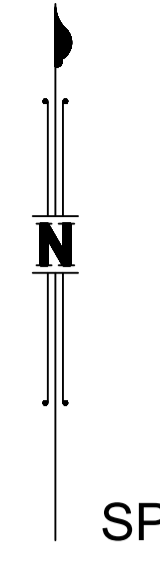
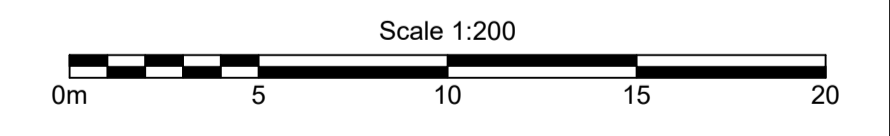

B.B.H.PTY. LTD ABN 010 427 531
(trading as Bennett and Bennett Group) hereby certify that the vertical and horizontal locations, and dimensions shown on this plan are a true and correct record of the As-Constructed information.

Agent
Date

I, hereby certify that the As Constructed information shown on this plan is a true and correct record of sizes, types, materials, classes etc, and it corresponds with the relevant approved Engineering Drawings

Signed
RPEQ No. Date

Revisions

Rev	Description	Date	Initial
A	ORIGINAL	08/04/2025	NR

WATERMAIN - AS CONSTRUCTED
STAGE 2M
CALYPSO BAY ESTATE
OPW/2021/1944

Client:	Roche Group Pty Ltd
Job No:	180649
Authority:	Council of the City of Gold Coast
Plan No:	180649_S043_ASC_2M-WAT.pdf
DWG File:	180649_S043_ASC_2M-WAT.dwg
Level Origin & Datum:	PM164830 2.887 AHD
Scale:	1:200 @ A1
Drawn:	BDH
Date:	17/04/25

BENNETT + BENNETT
PO Box 5021, GCMC QLD 9726
Ph: (07) 5631 8000
mail@bennettandbennett.com.au
www.bennettandbennett.com.au

Denotes Indicative Driveway Location

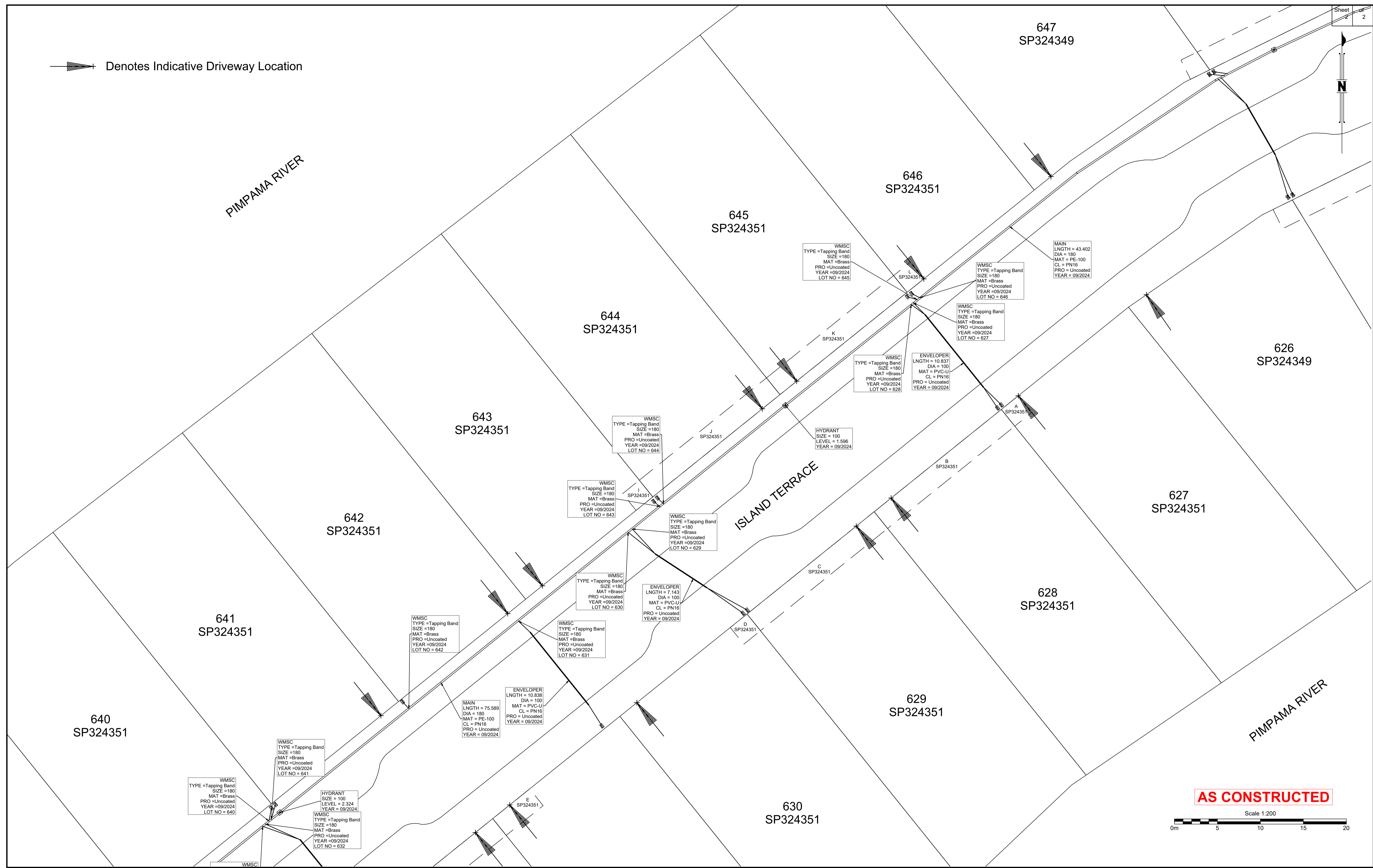

AS CONSTRUCTED

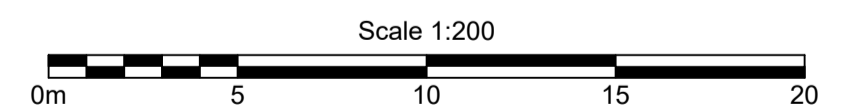

B.B.H.PTY. LTD ABN 010 427 531
(trading as Bennett and Bennett Group) hereby certify that the vertical and horizontal locations, and dimensions shown on this plan are a true and correct record of the As-Constructed information.

Agent
Date

I, hereby certify that the As Constructed information shown on this plan is a true and correct record of sizes, types, materials, classes etc, and it corresponds with the relevant approved Engineering Drawings

Signed
RPEQ No. Date

Revisions			
Rev	Description	Date	Initial
A	ORIGINAL	08/04/2025	NR

WATERMAIN - AS CONSTRUCTED
STAGE 2M
CALYPSO BAY ESTATE
 OPW/2021/1944

Client: Roche Group Pty Ltd
 Job No: 180649
 Authority: Council of the City of Gold Coast
 Plan No: 180649_S043_ASC_2M-WAT.pdf
 DWG File: 180649_S043_ASC_2M-WAT.dwg
 Level Origin & Datum: PM164830 2.887 AHD
 1:1000 @ A1 Drawn: BDH
 Date: 17/04/25

BENNETT + BENNETT
 PO Box 5021, GCMC QLD 9726
 Ph: (07) 5631 8000
 mail@bennettandbennett.com.au
 www.bennettandbennett.com.au