

MH 4/G
 SIZE = 2100
 COV = Circ Cast Iron
 SL = 2.400
 DEPTH = 2.530

Denotes Indicative Driveway Location

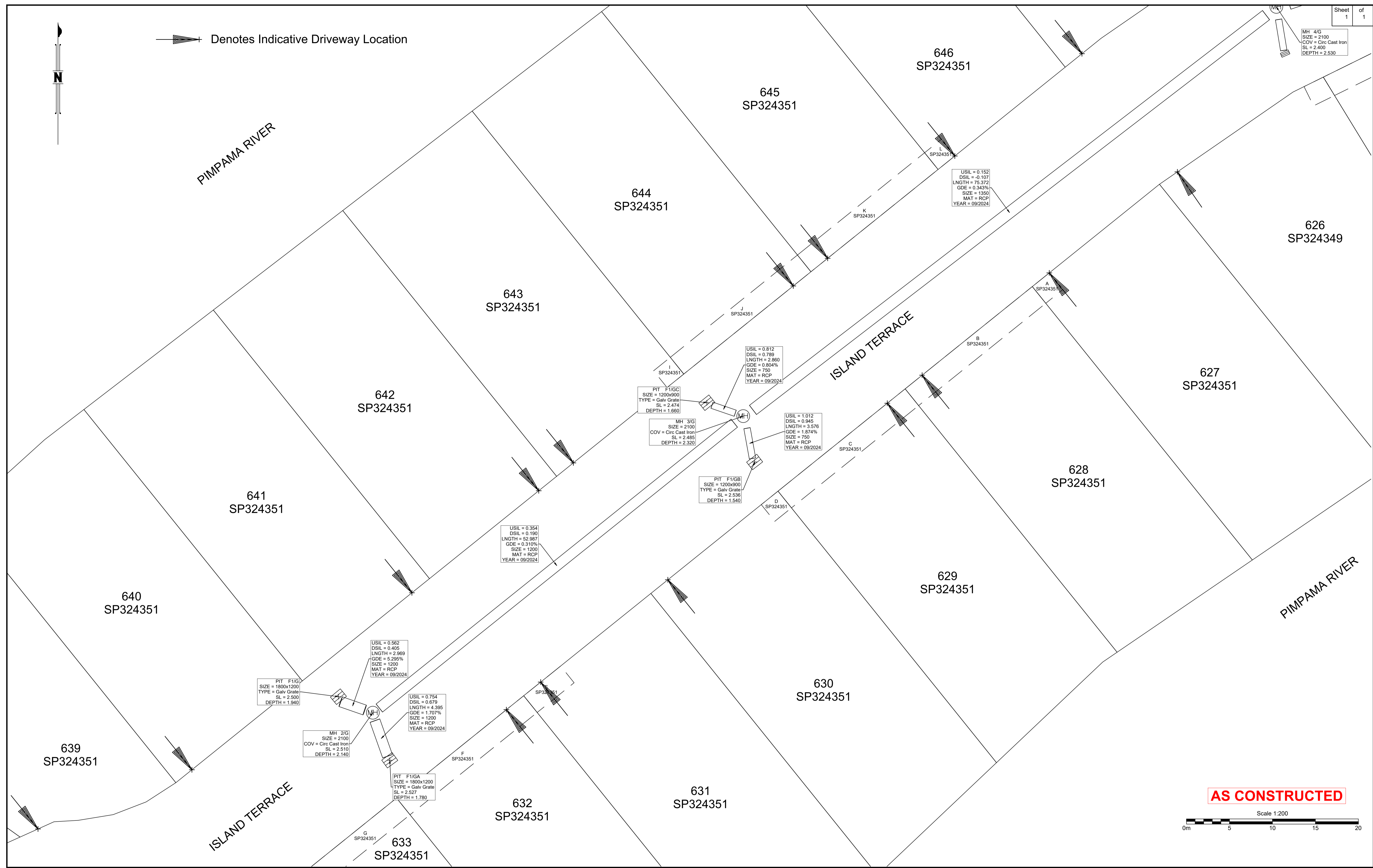

AS CONSTRUCTED

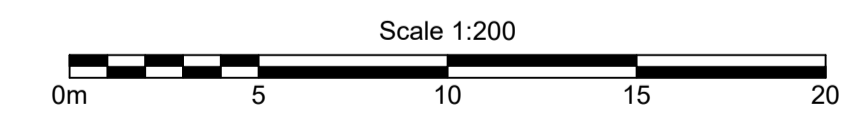

B.B.H.PTY. LTD ABN 010 427 531
 (trading as Bennett and Bennett Group) hereby certify
 that the vertical and horizontal locations, and
 dimensions shown on this plan are a true and
 correct record of the As-Constructed information.

I,
 hereby certify that the As Constructed
 information shown on this plan is a true and
 correct record of sizes, types, materials,
 classes etc, and it corresponds with the
 relevant approved Engineering Drawings

Signed
 RPEQ No. Date

Revisions			
Rev	Description	Date	Initial
A	ORIGINAL	06/04/2025	NR

STORMWATER - AS CONSTRUCTED
 STAGE 2M
 CALYPSO BAY ESTATE
 OPW/2021/1944

Client: Roche Group Pty Ltd
 Job No: 180649
 Authority: Council of the City of Gold Coast
 Plan No: 180649_S042_ASC_2M-SW.pdf
 DWG File: 180649_S042_ASC_2M-SW.dwg

Level Origin & Datum: PM164830
 2.887 AHD
 1:200 @ A1 Drawn: BDH
 Date: 17/04/25

BENNETT + BENNETT

PO Box 5021, GCMC QLD 9726
 Ph: (07) 5631 8000
 mail@bennettandbennett.com.au
 www.bennettandbennett.com.au