

VALVE
SIZE = 250
LEVEL = 1.87
YEAR = 11/2023

WMSC
TYPE =Tapping Band
SIZE =250
MAT =PE
PRO =Uncoated
YEAR =11/2023
LOT NO =448

WMSC
TYPE =Tapping Band
SIZE =250
MAT =PE
PRO =Uncoated
YEAR =11/2023
LOT NO =448, 449

WMSC
TYPE =Tapping Band
SIZE =250
MAT =PE
PRO =Uncoated
YEAR =11/2023
LOT NO =652, 653

HYDRANT
SIZE = 100
LEVEL = 1.56
YEAR = 11/2023

WMSC
TYPE =Tapping Band
SIZE =250
MAT =PE
PRO =Uncoated
YEAR =11/2023
LOT NO =450

WMSC
TYPE =Tapping Band
SIZE =250
MAT =PE
PRO =Uncoated
YEAR =11/2023
LOT NO =451

WMSC
TYPE =Tapping Band
SIZE =250
MAT =PE
PRO =Uncoated
YEAR =11/2023
LOT NO =452

WMSC
TYPE =Tapping Band
SIZE =250
MAT =PE
PRO =Uncoated
YEAR =11/2023
LOT NO =453

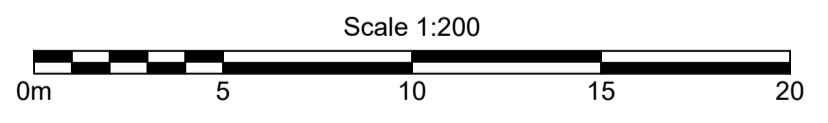

B.B.H.PTY. LTD ABN 010 427 531
(trading as Bennett and Bennett Group) hereby certify
that the vertical and horizontal locations, and
dimensions shown on this plan are a true and
correct record of the As-Constructed information.

Agent
Date

I,
hereby certify that the As Constructed
information shown on this plan is a true and
correct record of sizes, types, materials,
classes etc, and it corresponds with the
relevant approved Engineering Drawings

Signed
RPEQ No. Date

Revisions			
Rev	Description	Date	Initial
A	ORIGINAL	21/02/2025	BDH

WATERMAIN- AS CONSTRUCTED
STAGE 2K
CALYPSO BAY ESTATE
OPW/2021/1944

Client:	Roche Group Pty Ltd
Job No:	180649
Authority:	Council of the City of Gold Coast
Plan No:	180649_S039_ASC.pdf
DWG File:	180649_S039_ASC.dwg
Level Origin & Datum:	PM164830 2.887 AHD
Scale:	1:200 @ A1
Drawn:	BDH
Date:	21/02/25

BENNETT + BENNETT
PO Box 5021, GCMC QLD 9726
Ph: (07) 5631 8000
mail@bennettandbennett.com.au
www.bennettandbennett.com.au

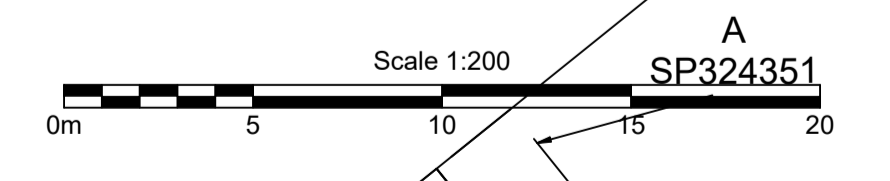
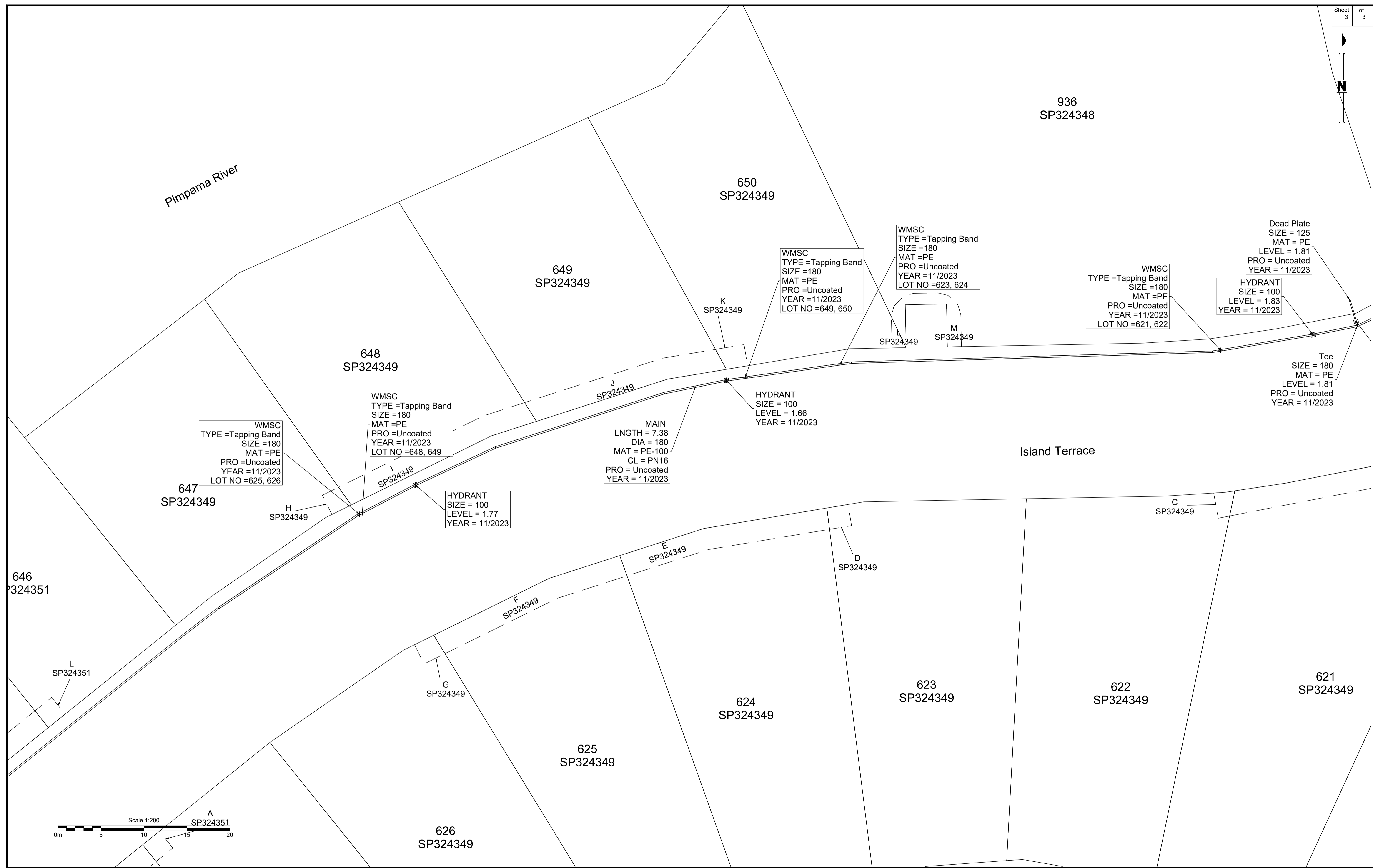
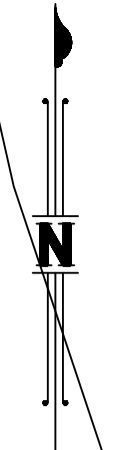

B.B.H.PTY. LTD ABN 010 427 531
(trading as Bennett and Bennett Group) hereby certify
that the vertical and horizontal locations, and
dimensions shown on this plan are a true and
correct record of the As-Constructed information.

.....
Agent
.....
Date

I,,
hereby certify that the As Constructed
information shown on this plan is a true and
correct record of sizes, types, materials,
classes etc, and it corresponds with the
relevant approved Engineering Drawings

Signed,
RPEQ No. Date

Revisions			
Rev	Description	Date	Initial
A	ORIGINAL	21/02/2025	BDH

WATERMAIN- AS CONSTRUCTED
STAGE 2K
CALYPSO BAY ESTATE
OPW/2021/1944

Client:	Roche Group Pty Ltd
Job No:	180649
Authority:	Council of the City of Gold Coast
Plan No:	180649_S039_ASC.pdf
DWG File:	180649_S039_ASC.dwg
Level Origin & Datum:	PM164830 2.887 AHD
1:1000 @ A1	Drawn: BDH
Date:	21/02/25

BENNETT + BENNETT

PO Box 5021, GCMC QLD 9726
Ph: (07) 5631 8000
mail@bennettandbennett.com.au
www.bennettandbennett.com.au